

FITTING INSTRUCTION

Clamp mark in acc. with		Cables joining
ISO	PN	
1	L	Left directional lights
2	+	Rear fog lights
3	31	Ground
4	R	Right directional lights
5	58R	Right side parking lights
6	54	Stoplights
7	58L	Left side parking lights

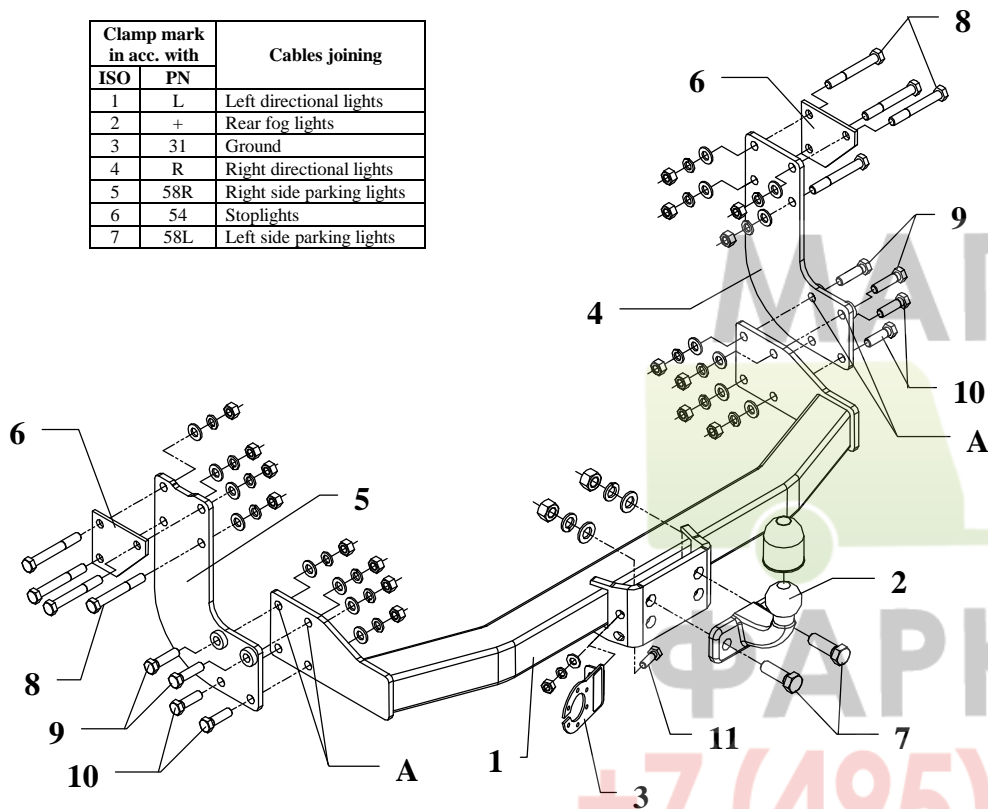

The towbar can be used in the following car:

- **MERCEDES SPRINTER** produced since 1995 till 03.2006
- **VOLKSWAGEN LT 28/46** produced since 1995 till 03.2006

Length 3,55/4,025 m, with step board, single wheels, catalogue no. **D19** and is prepared to tow trailers max total weight **2800 kg** and max vertical load **100 kg**.

From manufacturer

Thank you for buying our product. Their reliability has been confirmed in many tests. Reliability of towbar depends also on correct assembly and right exploit. For this reasons we kindly ask to read carefully this instruction and apply to hints.

The towbar should be installed in points described by a car producer.

The instruction of the assembly

1. Twist off bolts fastening step board, from the car frame on the left and right side of the car.
2. From inside of a frame apply fish-plates (pos. 6) in this way so holes of the fish-plates agree with holes in car's frame and put in bolts M12x90mm (pos. 8) from towbar equipment .
3. From inside of a frame of chassis put side brackets (pos. 4 and 5) on protruding bolts M12. Fix it by nuts M12 from the towbar equipment.
4. Drill $\varnothing 13\text{mm}$ through holes pos. A and step board support's holes.
5. Put main bar of the towbar (pos. 1) between installed side brackets (pos. 4 and 5), and fix it using bolts M12x45mm (pos. 9) and M12x40mm (pos. 10) from equipment.
6. Fix the ball of towbar (pos. 2) by bolts M16x50mm (pos. 7) as shown on the figure.
7. Fix the socket plate (pos. 3) using bolt M10x30mm (pos. 11) as shown on the drawing.
8. Tighten all nuts and bolts according to the torque shown in the table.
9. Connect to the electric wires according to the instructions of the car.
10. Complete the paint cover of towbar (during the mounting paint cover could be destroyed).

Torque settings for nuts and bolts (8,8):

M6 - 11 Nm	M8 - 25 Nm	M10 - 50 Nm
M12 - 87 Nm	M14 - 138 Nm	M16 - 210 Nm

NOTE

After install the towbar you should get adequate note in registration book (at authorised service station). The car should be equipped with:

- Indicators
- Tow mirrors

After 1000km of exploitation check all bolts and nuts. The ball of towbar must be always kept clear and conserve with a grease.

Part list:

Pos. 1 Main bar PCS.: 1	Pos. 5 Left bracket PCS.: 1	Pos. 10 Bolt 8,8 B M12x40mm PCS.: 4	Pos. 16 Spring washer ø12mm PCS.: 16
		Pos. 11 Bolt 8,8 B M10x30mm PCS.: 1	Pos. 17 Spring washer ø10mm PCS.: 1
Pos. 2 Tow ball pcs.: 1	Pos. 6 Fish-plate PCS.: 2	Pos. 12 Plain washer ø17mm PCS.: 2	Pos. 18 Nut 8 B M16 PCS.: 2
Pos. 3 Socket plate pcs.: 1	Pos. 7 Bolt 8,8 B M16x50mm PCS.: 2	Pos. 13 Plain washer ø12mm PCS.: 16	Pos. 19 Nut 8 B M12 PCS.: 16
Pos. 4 Right bracket PCS.: 1	Pos. 8 Bolt 8,8 B M12x90mm PCS.: 8	Pos. 14 Plain washer ø10mm PCS.: 1	Pos. 20 Nut 8 B M10 PCS.: 1
	Pos. 9 Bolt 8,8 B M12x45mm PCS.: 4	Pos. 15 Spring washer ø16,3mm PCS.: 2	Pos. 21 Ball cover PCS.: 1



PPUH AUTO-HAK S. J.

Produkcja Zaczepów Kulowych
Henryk & Zbigniew Nejman
76-200 SŁUPSK ul. Słoneczna 16K
tel/fax (059) 8-414-414; 8-414-413
E-mail: office@autohak.com.pl
www.autohak.com.pl

Towing hitch (without electrical set)

Class: **A50-X** Cat. no. **D19**

Designed for:

MERCEDES SPRINTER and
VOLKSWAGEN LT 28/46

Type: length 3,55/4,025 m, with step board,
single wheels

produced since 1995 till 03.2006

Approval number acc. to regulations EKG/ONZ 55.01: E20-55R-01 0895

Technical data:

D-value: 13,75 kN

maximum trailer weight: **2800 kg**

maximum vertical cup load: **100 kg**

Foreword

This towing hitch is designed according to rules of safety traffic regulations. The towing hitch is a safety component and can be install only by qualified personnel. Any alteration or conversion of the towing hitch is prohibited and would lead to cancellation of design certification. Remove insulating compound and underseal from vehicle (if present) in the areas of the matting surfaces of the towing hitch. The vehicle manufacturer's specifications regarding trailer load and max. vertical cup mass are decisive for driving whereat values for the towing hitch cannot be exceeded.

D-value formula:

$$\frac{\text{Max trailer weight [kg]} \times \text{Max vehicle weight [kg]}}{\text{Max trailer weight [kg]} + \text{Max vehicle weight [kg]}} \times \frac{9,81}{1000} = D \text{ [kN]}$$